

**SABRI Estates
P.O. Box 69
St. Anthony, NL
A0K 4S0**

Rules, Guidelines, and Application

Rental Housing at 2 High School Road, St. Anthony, NL

1. Priority for housing will be given to long-term residents of the SABRI Region (North Boat Harbour to Goose Cove); who are able to live independently.
2. Tenants shall be 55 years of age or older or involuntarily retired from the work force and at least 50 years of age. (SABRI Estates has the right to waive this rule if an apartment(s) is vacant and will not be filled by such tenants.)
3. 26 apartments will be available for rent:
 - 4 of the 26 will be designated for Rent Geared to Income for tenants with a household income of \$40,000 or less. Proof of income (Notice of Assessment) will be required at the time of application. Rent will be \$800 per month, and pay your own utilities for these 4 units. The units will be located in a 4-unit building.
 - For the remaining 22 apartments rent will be \$1,000 per month, and pay your own utilities.
4. There shall not be more than two tenants per unit; exceptions to this are at the discretion of SABRI Estates.
5. Pets are not permitted.
6. Smoking is strictly prohibited.
7. Collecting or storing debris on the property is prohibited.
8. Door keys are not to be copied. Extra copies can be obtained by contacting SABRI Estates.
9. Alterations, renovations, or adjustments to the building by tenants is not permitted.

10. Tenants responsible for:

- Washer & dryer.
- All fees such as electricity, cable, internet, phone.
- Tenants insurance with SABRI named as additional insured; SABRI Estates is not responsible for personal property lost, stolen, or damaged.
- Informing Landlord of any changes to application; i.e. mailing or email address, telephone number, etc.
- Payment of monthly rent as set out in the rental agreement.
- Damage deposit of 75% of one-month rent, prior to taking keys.
- \$200 application fee; to be credited to damage deposit if applicant becomes tenant. Refundable if application is no longer active.

11. Landlord is responsible for:

- Maintenance of the building and equipment that is owned by the landlord.
- Lawn Care.
- Snow clearing of driveway and walkway once per day.

Name of Applicant _____

Address _____

Email _____

Telephone Number _____

Name of Co-Applicant _____

Address (if different from above) _____

Email _____

Telephone Number _____

Please state a date that you will be ready to occupy an apartment if your application is successful:

Are you applying for one of the apartments designated for Rent Geared to Income?

_____ yes _____ no

If yes, please attached a copy of your most recent Notice of Assessment as proof of income.

In the case that a Rent Geared to Income apartment is not available, do you want your application then considered for the \$1,000 per month units?

_____ yes _____ no

Date _____

Date _____

Signature of Applicant

Signature of Co-Applicant

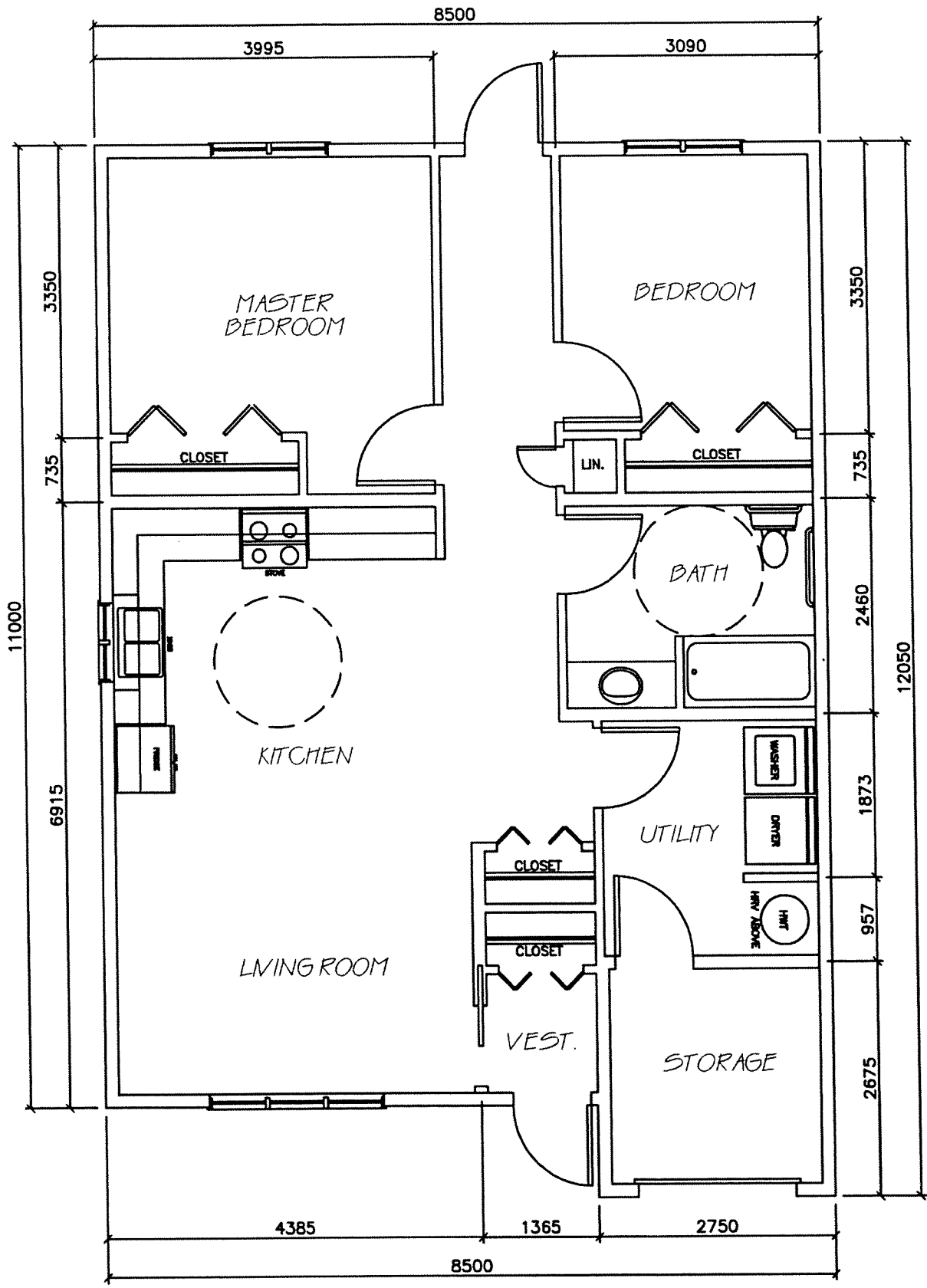

W T E
S

